

WEIGHT TROLLEY WITH ELECTRIC MOTOR

Avoid repeated lifting and moving of heavy weights that could lead to occupational injuries, by using a weight trolley.

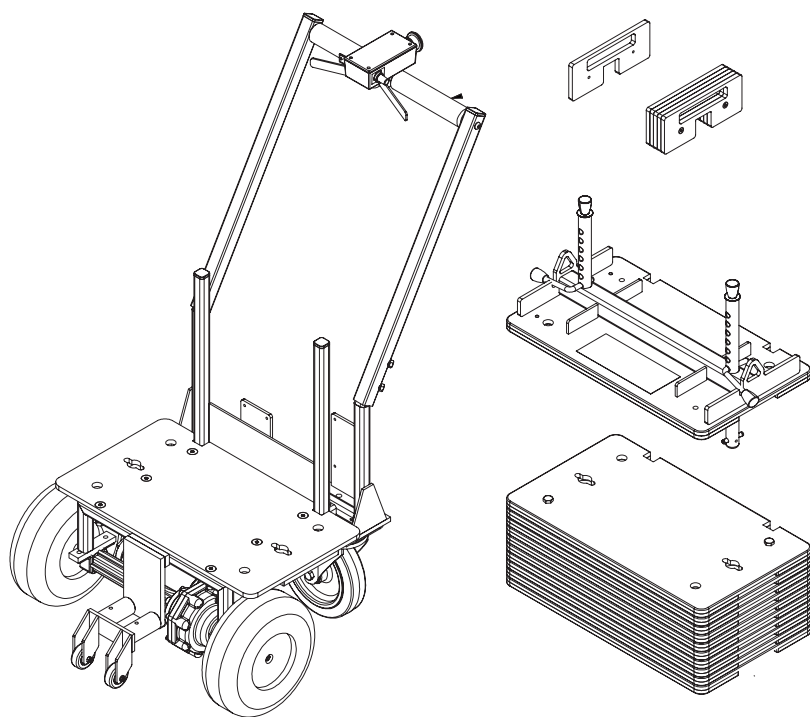

Experience an improved work environment by using a weight trolley, and avoid heavy lifts and moves of weights when testing lifting equipment.

Transporting heavy loads can be risky which is why, in cooperation with people, who live with these problems every day, we have developed a smart and compact trolley. The trolley will do the job for you, sparing you wear and tear on the foot and knee joints, back elbows and shoulders.

The motor has plenty of pulling power and is stepless-regulated in both directions. The top speed can be adjusted to match the user's walking speed.

The standard model weight trolley comes with a grey chassis, a top and bottom section plus 10 white weight blocks of 25 kg each that allow you to load between 50 - 350 kg in 25 kg increments. An extra 25 kg weight block can be provided, and a set of 1 kg and 5 kg weight blocks, which in total provide the option of loading 25 -408 kg at increments of 1 kg.

Weight trolley # 700111			
Measurements	H: 1200 mm, W: 600 mm, L: 800 mm	Increase capacity	10°
Weight, empty trolley without blocks	75 kg	Engine power	350 W
Batteries	2 x 12 V, 9 Ah	Max total weight	408 kg
Charger - charging time	24 V 2,5 A - 4 hours	Weight tolerance, uncalibrated	2%
Driving distance per charge	6 km	Anti-tip	Yes
Speed	0 - 6 km/h	Run time environment	-10/+40°C, 10-90% RH, non-condensing

IMMO A/S

Friis Hansens Vej 9 - DK-7100 Vejle
+45 7585 8022
hello@immodenmark.dk
immodenmark.dk

IMMO  **KEEP MOVING**